

## Φ16金屬按鈕開關 Metal Push Button Switch

產品外觀

技術參數

外形尺寸



GQ-16F

安裝尺寸Diameter: Φ16mm  
 開關額定值Switch Rating: 3A/250VAC  
 開關組合  
 Contact Configuration:1NO  
 操作類型Operation Type: 自復型Momentary  
 頭部形狀The Front Shape: 平面 Flat  
 外殼材料  
 The Crust Material: 不銹鋼Stainless steel  
 銅鍍鎳Copper plating  
 防護等級IP Degree:IP67,IK10

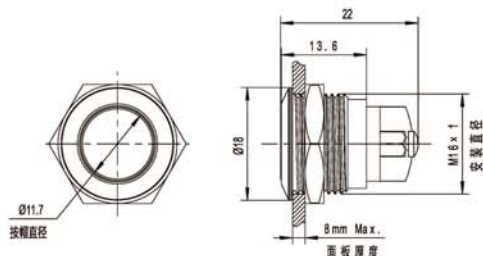

GQ-16B

安裝尺寸Diameter: Φ16mm  
 開關額定值Switch Rating: 3A/250VAC  
 開關組合  
 Contact Configuration:1NO  
 操作類型Operation Type: 自復型Momentary  
 頭部形狀The Front Shape: 球面 Ball  
 外殼材料  
 The Crust Material: 不銹鋼Stainless steel  
 銅鍍鎳Copper plating  
 防護等級IP Degree:IP67,IK10

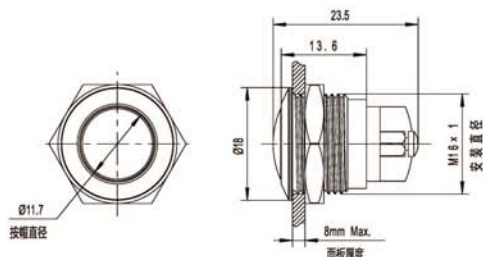

GQ-16H

安裝尺寸Diameter: Φ16mm  
 開關額定值Switch Rating: 3A/250VAC  
 開關組合  
 Contact Configuration:1NO  
 操作類型Operation Type: 自復型Momentary  
 頭部形狀The Front Shape: 高頭 High  
 外殼材料  
 The Crust Material: 不銹鋼Stainless steel  
 銅鍍鎳Copper plating  
 防護等級IP Degree:IP67,IK10

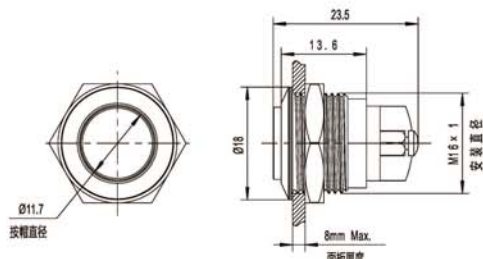

產品規格	Specification	GQ-16F	GQ-16B	GQ-16H
尾部配置	Terminal Type	接线柱Wiring terminal	接线柱Wiring terminal	接线柱Wiring terminal
開關結構	Switching	NO.1	NO.1	NO.1
開關規格	Max. Switch Rating	3A/250VAC	3A/250VAC	3A/250VAC
接觸電阻	Contact Resistance	≤50mΩ	≤50mΩ	≤50mΩ
絕緣電阻	Insulation Resistance	≥1000MΩ	≥1000MΩ	≥1000MΩ
絕緣強度	Dielectric Intensity	2000VAC	2000VAC	2000VAC
環境溫度	Operating Temp	-20℃~+55℃	-20℃~+55℃	-20℃~+55℃
機械壽命	Mechanical Life	100萬次以上 1,000,000 cycles	100萬次以上 1,000,000 cycles	100萬次以上 1,000,000 cycles
電氣壽命	Electrical Life	20萬次以上200,000 cycles	20萬次以上200,000 cycles	20萬次以上200,000 cycles
面板厚度	Panel Thickness	1-6mm	1-6mm	1-6mm
螺母扭矩	Torque	5-14Nm	5-14Nm	5-14Nm
操作壓力	Operation Pressure	約4N About 4N	約4N About 4N	約4N About 4N
操作行程	Operation Travel	約1.5mm About 1.5mm	約1.5mm About 1.5mm	約1.5mm About 1.5mm
防護等級	IP Degree	IP67,IK10	IP67,IK10	IP67,IK10
Material	觸點	銀鍍金Silver Plated Gold	銀鍍金Silver Plated Gold	銀鍍金Silver Plated Gold
	按鍵	不銹鋼Stainless steel 銅鍍鎳Copper plating	不銹鋼Stainless steel 銅鍍鎳Copper plating	不銹鋼Stainless steel 銅鍍鎳Copper plating
	外殼	不銹鋼Stainless steel 銅鍍鎳Copper plating	不銹鋼Stainless steel 銅鍍鎳Copper plating	不銹鋼Stainless steel 銅鍍鎳Copper plating
	底座	聚碳酸酯PC	聚碳酸酯PC	聚碳酸酯PC
	RohS	RohS	可定制Made to order	可定制Made to order
帶燈	帶燈類型	Lamp type		
部分參數 LED Spec.	額定電壓	Rated Voltage(Ue)		
	燈珠顏色	Color		
	燈珠壽命	Life		